

Features

FRONT VIEW

- 1. WHITE LED** - Illuminates when the Control 2P is connected to a power source and the POWER SWITCH is set to ON.
- 2. RED LED** - Flashes intermittently when the Control 2P approaches thermal protect mode. When the Red LED is flashing, system volume should be reduced. When the Red LED glows continuously, the Control 2P should be turned-off and allowed to cool before re-powering the system.
- 3. SNAP-ON PEDESTAL** - Use these adapters to adjust the vertical coverage angle of the Control 2P for optimum performance in desk-top applications.

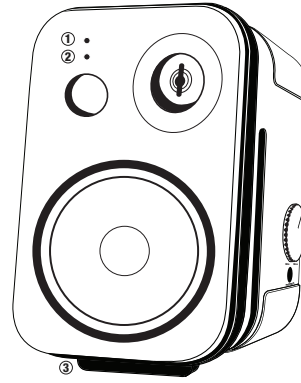

SIDE VIEW

- 4. VOLUME CONTROL** - Adjusts the volume output of the Control 2P and connected extension speaker.
- 5. HEADPHONE JACK** - 3.5 mm (1/8") stereo jack for headphones. When headphones are connected to this jack, the speakers are automatically muted. CAUTION: listening to music at high volume levels using headphones may lead to hearing damage.

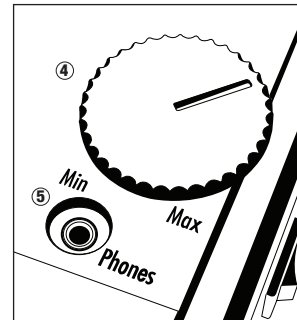

REAR VIEW

- 6. POWER SWITCH** - Turns the Control 2P system OFF and ON.
- 7. MOUNTING BRACKET ATTACHMENT POINT** - This 1/4" x 20 TPI (threads per inch) fitting allows attachment of the optional MTC-2P wall mounting bracket.*
- 8. SAFETY HOOK** - Attach suitable safety cable to this hook when mounting speakers.*
- 9. MASTER XLR/1/4" INPUT** - A combination XLR and TRS balanced line-level input. 3-pin XLR or 1/4" TRS connectors can be connected to this jack. Note: if a signal is connected to this jack only, sound will only emanate from the Control 2P Master loudspeaker. Signal will not be fed to both loudspeakers.
- 10. EXTENSION SPEAKER XLR/1/4" INPUT** - A combination XLR and TRS balanced line-level input. 3-pin XLR or 1/4" TRS connectors can be connected to this jack. NOTE: If a signal is connected to this jack only, sound will only emanate from the Control 2P Extension loudspeaker. Signal will not be fed to both loudspeakers.
- 11. DC POWER INPUT** - Input connector for the external power supply.
- 12. RCA INPUTS** - Unbalanced input jacks for RCA style connectors. NOTE: if a signal is connected to the red RCA input jack, sound will only emanate from the Control 2P Master loudspeaker. If a signal is connected to the white RCA input jack, sound will only emanate from the Control 2P Extension loudspeaker. NOTE: Do not simultaneously connect sources to the RCA inputs and the XLR/1/4" inputs. Doing so may compromise performance.
- 13. HF ADJUST SWITCH** - Use this switch to adjust the amount of high frequency produced by the loudspeaker(s). The 0 dB setting is the normal setting. Use the -2 dB setting to decrease the amount of high frequency produced by the speakers. Use the +2 dB setting to increase the amount of high frequency produced by the speakers.
- 14. EXTENSION SPEAKER JACK** - 1/4" output jack for connection of the Control 2P Extension loudspeaker to the Control 2P Master loudspeaker. When the extension speaker cable plug (included) is removed from this jack, the extension speaker amplifier channel is automatically muted.
- 15. SAFETY BAR** - An attachment point for connection of an optional safety cable or lanyard from an independent secured mount point.*

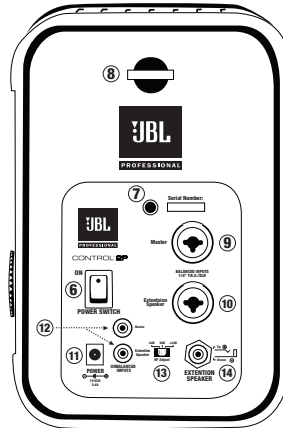

Applications

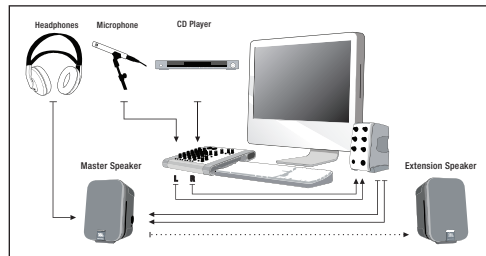

Recording/ Video Production

The Control 2P adds accurate monitoring to professional desk-top recording and video production systems. Connect a pair of headphones to the master speaker headphone jack for private monitoring.

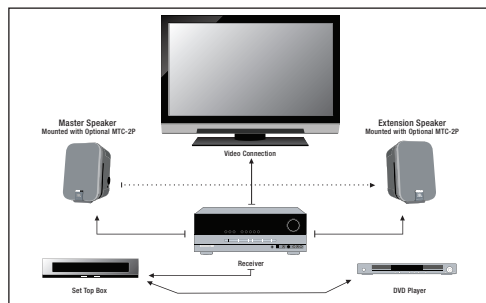

Entertainment Installation

With the optional MTC-2P kit, the Control 2P can be wall-mounted to provide professional quality audio for home and office entertainment installations.

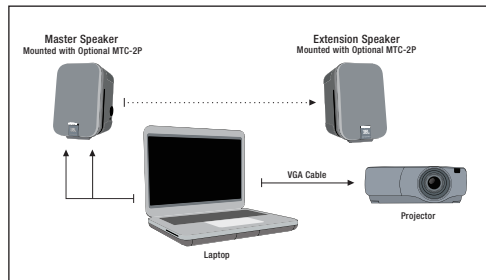

AV Presentations

A pair of Control 2P compact powered monitors, a portable projector and a laptop computer, make a "go-anywhere" presentation system.

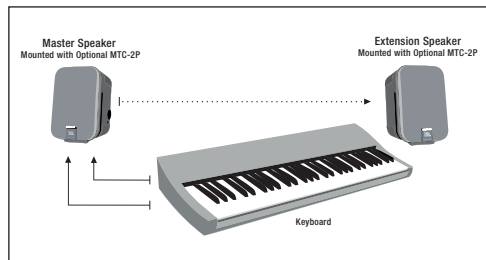

Electronic Musical Instruments

The Control 2P has the input connectors and the power to reproduce a wide range of signal sources including electronic Musical Instruments.

- For desk-top applications, attach a supplied angle pedestal to the bottom of each speaker as shown.
- Position speakers on a desk-top or secure surface. The Control 2P can be wall-mounted using optional MTC-2P mounting kit.*
- Connect the C2P extension speaker to the master speaker using the supplied extension speaker wire as illustrated. To ensure proper polarity, connect wire with red sleeve to the red speaker terminal.
- Connect the Control 2P power supply to the Control 2P Master Loudspeaker Power Connector.
- Connect the signal source to the inputs of the Control 2P Master Loudspeaker. Do not simultaneously connect sources to the RCA inputs and the XLR/ 1/4" inputs. Doing so may compromise performance.
- Set the POWER SWITCH to the ON position.
- With the sound source producing signal, set the volume control to achieve a suitable listening level.

ENGLISH

Trouble Shooting

If there is no sound from your speakers, check these settings on the C2P Master Speaker:

- Make sure a signal source is connected and producing sound
- Make sure the white power ON LED is illuminated on the front of the speaker.
- Confirm the included power supply is connected and the power switch is set to the ON position.
- Make sure the volume control is not set to the full counter clockwise position
- If the C2P Extension Speaker does not produce sound, make sure the extension speaker wire 1/4" plug is connected to the EXTENSION SPEAKER 1/4" output connector. Make sure the bare-wire end of the cable is connected to the extension speaker wire terminals.
- If the system sounds as if it lacks low frequency (bass) performance, confirm the bare wire is connected so the RED wire is connected to the RED speaker wire terminal, and the other wire is connected to the BLACK speaker wire terminal.

If the above measures do not correct the problem, please contact JBL Professional

NOTE: If the red LED on the front of the speaker flashes due to continuous over-driving of the system, overload-protection may be activated and no sound will be heard. To resume operation, reduce system volume, turn the power switch OFF and then ON again.

Specifications

Frequency Response (+/- 3dB):	100 Hz – 18 kHz
Frequency Range (-10dB):	80 Hz - 20 kHz
Maximum Peak SPL C2PM Master Only ¹:	111 dB (1)
Maximum Peak SPL Per-Pair ¹:	115 dB (1)
LF Transducer:	135 mm (5.25 in) low frequency loudspeaker
HF Transducer:	19 mm (.75 in) polycarbonate dome tweeter
Overload Protection:	Internal Peak Limiter and Overload Protection
Crossover Frequency:	4.2 kHz
Signal Input Connectors (x2):	Balanced Neutrik ^{®2} Combo XLR 1/4" TRS; Unbalanced RCA
Input Sensitivity:	+4 dBu XLR / 1/4"; 0 dBu RCA
Amplifier Power:	35 Watts continuous per-channel
Power Requirements:	19 VDC / 3.42 A - use only supplied power supply
Headphone Jack:	3.5 mm (1/8")
Enclosure Material:	Polypropylene Structural Foam
Finish:	Black
Dimensions (H x W x D):	235 x 159 x 143 mm (9.3 x 6.3 x 5.6 in)
Net Weight Master Speaker:	2.6 kg (5.5 lb)
Net Weight Extension Speaker:	2.2 kg (4.5 lb)
Shipping Weight per Pair:	12.5 lb / 5.8 Kg
Optional Accessories:	MTC-2P Mounting Kit ³

¹ IEC Pink Noise at 1 meter.

² Neutrik and the names of Neutrik products referenced herein are either trademarks and/or service marks of Neutrik.

³ **CAUTION:** Unsafe mounting or overhead suspension of any heavy load can result in serious injury and equipment damage. Mounting of speakers should be done by qualified persons in accordance with all applicable local safety and construction standards. Be certain to follow the instructions provided by the manufacturer of the mounting bracket. Before selecting a mounting bracket, be certain that it is capable of supporting the weight of the speaker to be mounted.