



Middle Atlantic Products, Inc.

middleatlantic.com

## CL Series Cable Ladders and Accessories

EIA/TIA Compliant



### The CL Series 12" wide fully welded heavy-duty cable ladders and accessories

#### Features

- Ladder sections individually boxed with handles for ease of transport
- Compatible with most popular brands and accessories of cable ladders
- Works on both new and existing installations
- Highly scratch resistant, durable black powder coat
- A full line of hardware and accessories available
- UL Classified in the US and Canada

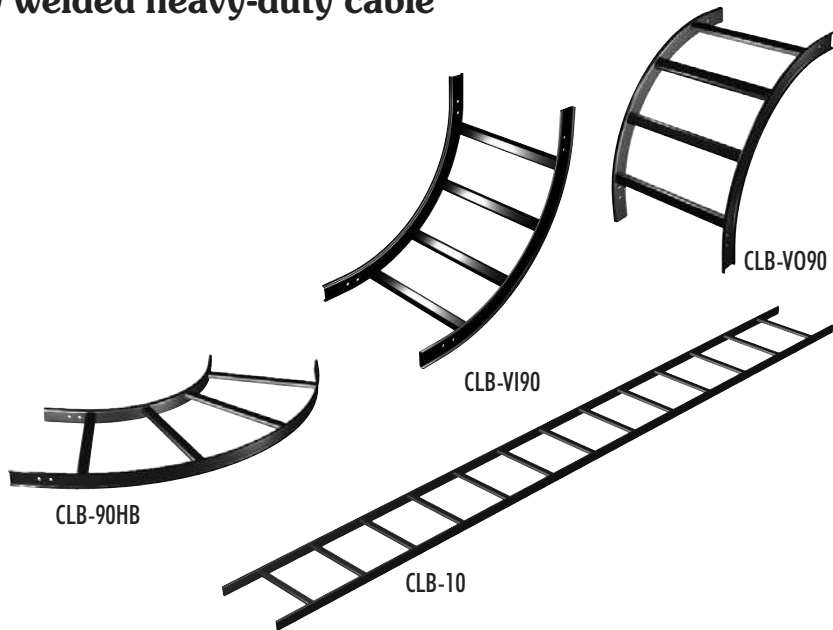

#### Architects' and Engineers' Specifications

##### CLB-10 / CLB-6

Single piece \_\_\_ (6', 10') long straight cable ladder sections shall be Middle Atlantic Products model # CLB-\_\_\_ (6, 10). Ladder sections shall be \_\_\_ (6', 10') long x 12" wide x 1.5" thick, rungs shall be 1" x .5" x 11.25". Ladder section shall have \_\_\_ (8, 13) rungs on 9" centers. Ladder shall be constructed of ASTM A570 structural steel finished in 2 layers of durable black powder coat. Each CLB series ladder section shall be individually boxed with handles. Ladders shall also be available in contractor packs of twelve, model # CLB-\_-12 (6, 10). CLB Series cable ladder shall have up to 187 lb. weight capacity per foot based on a 4 ft. support span. Cable ladder shall be classified by UL in the US and Canada.

##### CLB-90HB

90 degree horizontal bend cable ladder sections shall be Middle Atlantic Products model # CLB-90HB. Ladder sections shall be 12" wide x 27" long x 1.5" thick, rungs shall be 1" x .5" x 11.25". Ladder bend section shall have four rungs on 5.2" centers on inside of bend and 10.25" centers on outside of bend. Bend section shall be constructed of ASTM A570 structural steel finished in 2 layers of durable black powder coat. Each CLB series ladder section shall be individually boxed. Ninety degree horizontal bend shall be available in a contractor pack of four pieces, model # CLB-90HB-4. CLB-90HB-4 shall have up to 187 lb. weight capacity per foot based on a 4 ft. support span. Cable ladder shall be classified by UL in the US and Canada.

##### CLB-VI90 / CLB-VO90

90 degree vertical \_\_\_\_\_ (inside, outside) bend cable ladder sections shall be Middle Atlantic Products model # CLB-\_\_90 (VI, VO). Ladder sections shall be 12" wide x 15.5" long x 1.5" thick, rungs shall be 1" x .5" x 11.25". Ladder bend section shall have 4 rungs on \_\_\_ (4.8", 5.3") centers. Bend section shall be constructed of ASTM A570 structural steel finished in 2 layers of durable black powder coat. Each CLB series ladder section shall be individually boxed. Ninety degree vertical bend cable ladder sections shall also be available in a contractor pack of four pieces, model # CLB-\_\_90-4 (VI, VO). CLB-VI90 / CLB-VO90 shall have up to 187 lb. weight capacity per foot based on a 4 ft. support span. Cable ladder shall be classified by UL in the US and Canada.

customizable specification clips available at [middleatlantic.com](http://middleatlantic.com)

### Engineered Mounting Solutions

US: New Jersey • California • Illinois • Voice: 973-839-1011 Fax: 973-839-1976 • [middleatlantic.com](http://middleatlantic.com)  
Canada: Ontario • British Columbia • Voice: 613-836-2501 Fax: 613-836-2690 • [middleatlantic.ca](http://middleatlantic.ca)

# CL Series Cable Ladders and Accessories

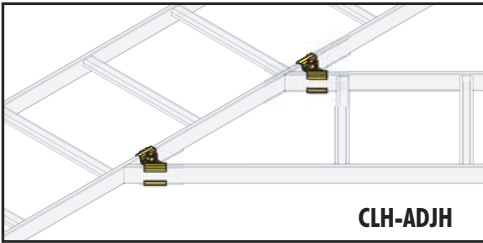

**CLH-ADJH**

Pair of adjustable horizontal splice hardware shall be Middle Atlantic Products model # CLH-ADJH. Hardware kit shall be of all steel construction with zinc coating. Shall also be available in a contractor pack of six pairs, model # CLH-ADJH-6. Classified by UL in the US and Canada.

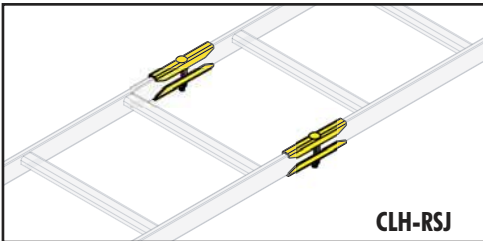

**CLH-RSJ**

Pair of ladder end splice hardware shall be Middle Atlantic Products model # CLH-RSJ. Hardware kit shall be of all steel construction with zinc coating. Shall also be available in a contractor pack of six pairs, model # CLH-RSJ-6. Classified by UL in the US and Canada.

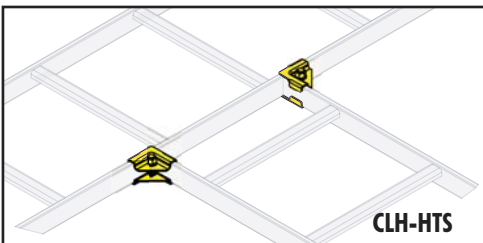

**CLH-HTS**

Pair of 90 degree horizontal tee splice hardware shall be Middle Atlantic Products model # CLH-HTS. Hardware kit shall be of all steel construction with zinc coating. Shall also be available in a contractor pack of six pairs, model # CLH-HTS-6. Classified by UL in the US and Canada.

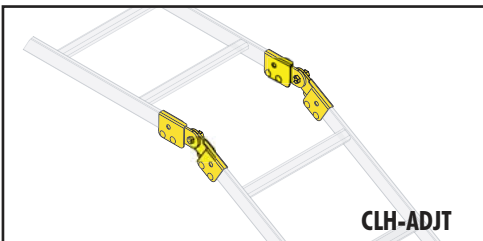

**CLH-ADJT**

Pair of adjustable ladder end splice hardware shall be Middle Atlantic Products model # CLH-ADJT. Hardware kit shall be of all steel construction with zinc coating. Shall also be available in a contractor pack of six pairs, model # CLH-ADJT-6. Classified by UL in the US and Canada.

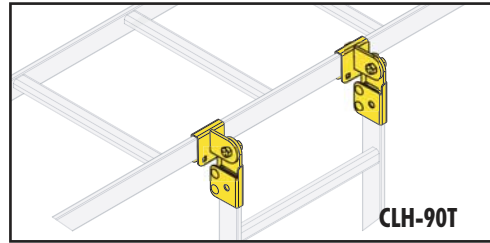

**CLH-90T**

Pair of adjustable 90 degree tee splice hardware shall be Middle Atlantic Products model # CLH-90T. Hardware kit shall be of all steel construction with zinc coating. Shall also be available in a contractor pack of six pairs, model # CLH-90T-6. Classified by UL in the US and Canada.

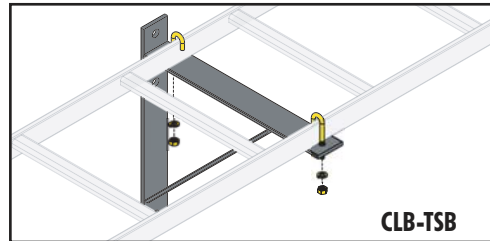

**CLB-TSB**

Triangle wall support brackets shall be Middle Atlantic Products model # CLB-TSB. Hardware kit shall be of all steel construction with black powder coat finish. Shall also be available in a contractor pack of six pieces, model # CLB-TSB-6.

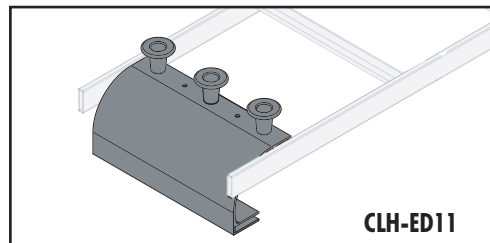

**CLH-ED11**

Cable ladder end drop with three cable spools shall be Middle Atlantic Products model # CLH-ED11. End drop shall be of aluminum construction with black powder coat finish. Cable spools shall be black plastic. Shall also be available in a contractor pack of four pieces, model # CLH-ED11-4. Classified by UL in the US and Canada.

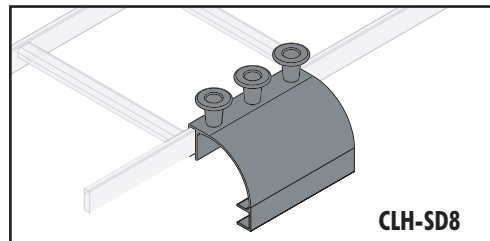

**CLH-SD8**

Cable ladder side drop with three cable spools shall be Middle Atlantic Products model # CLH-SD8. Side drops shall be of aluminum construction with black powder coat finish. Cable spools shall be black plastic. Shall also be available in a contractor pack of four pieces, model # CLH-SD8-4. Classified by UL in the US and Canada.



# CL Series Cable Ladders and Accessories

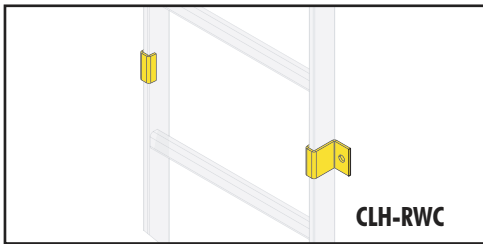

**CLH-RWC**

Pair of ladder wall clamps shall be Middle Atlantic Products model # CLH-RWC. Hardware kit shall be of all steel construction with zinc coating. Shall also be available in a contractor pack of six pairs, model # CLH-RWC-6.

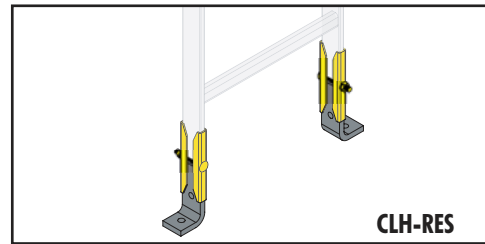

**CLH-RES**

Pair of ladder end support hardware shall be Middle Atlantic Products model # CLH-RES. Hardware kit shall be of all steel construction with zinc coating. Shall also be available in a contractor pack of six pairs, model # CLH-RES-6.

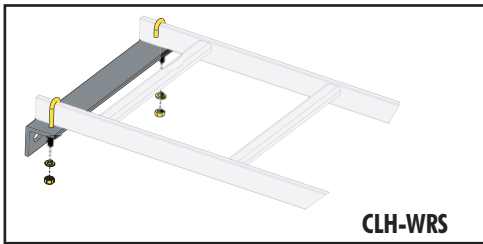

**CLH-WRS**

Ladder wall support shall be Middle Atlantic Products model # CLH-WRS. Hardware kit shall be of all steel construction with black powder/coat finish. Shall also be available in a contractor pack of six pieces, model # CLH-WRS-6.

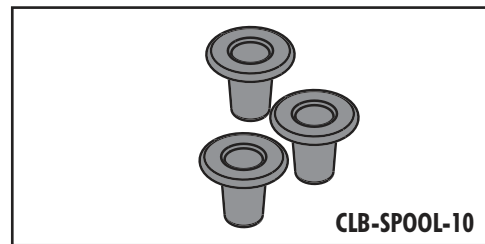

**CLB-SPOOL-10**

Pack of ten plastic cable spools shall be Middle Atlantic Products model # CLB-SPOOL-10. Cable spools shall be black plastic.

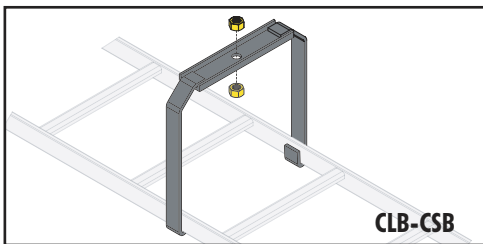

**CLB-CSB**

Ladder center support brackets shall be Middle Atlantic Products model # CLB-CSB. Hardware kit shall be of all steel construction with black powder/coat finish. Shall also be available in a contractor pack of six pieces, model # CLB-CSB-6.

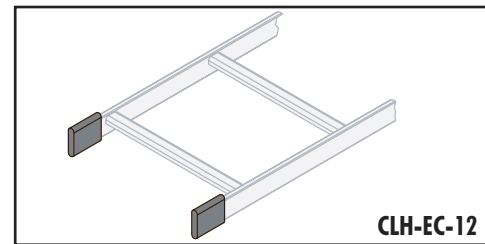

**CLH-EC-12**

Pack of six pairs of ladder end caps shall be Middle Atlantic Products model # CLH-EC-12. End caps shall be black rubber. Classified by UL in the US and Canada.

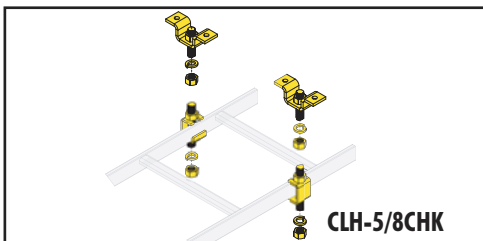

**CLH-5/8CHK**

Set of slotted ladder support hardware with ceiling hang kit shall be Middle Atlantic Products model # CLH-5/8CHK. Hardware kit shall be of all steel construction with zinc coating. Shall also be available in a contractor pack of six pairs, model # CLH-5/8CHK-6.

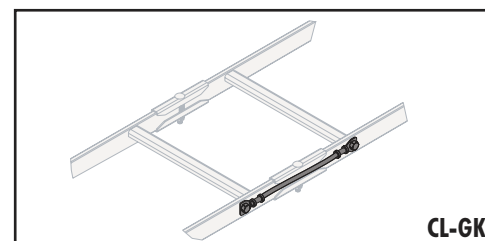

**CL-GK**

Cable ladder bonding kit shall be Middle Atlantic Products model # CL-GK. Classified by UL in the US and Canada.

Pair of J-Bolts shall be Middle Atlantic Products model # CLH-JBOLT.



# CL Series basic dimensions

All dimensions in inches unless otherwise noted [bracketed dimensions are in millimeters unless otherwise noted]

Cable Ladder Weight Capacity	
Support Span	Weight Rating Per Foot [meter]
4 ft. [1.2m]	187 lbs. [26 kg]
5 ft. [1.5m]	119 lbs. [16 kg]
6 ft. [1.8m]	83 lbs. [11 kg]
7 ft. [2.1m]	62 lbs. [9 kg]
8 ft. [2.4m]	50 lbs. [7 kg]

**FRONT VIEW**

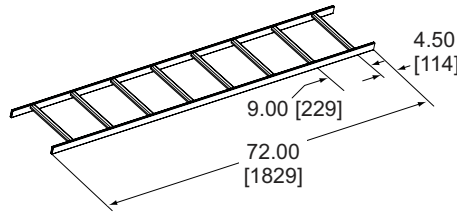
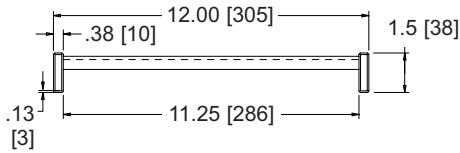

**CLB-6**

**FRONT VIEW**

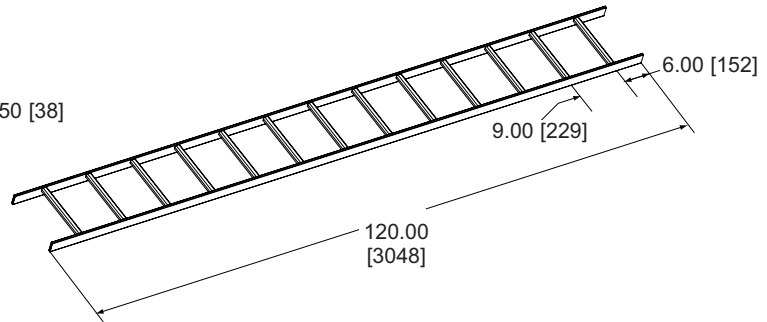
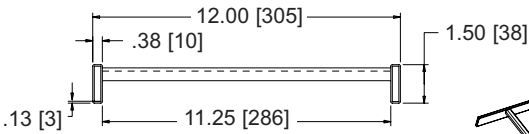

**CLB-10**

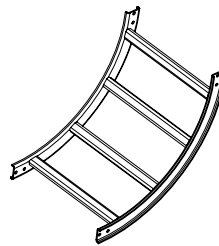
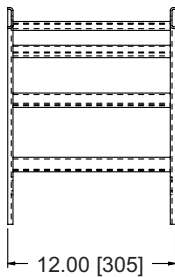
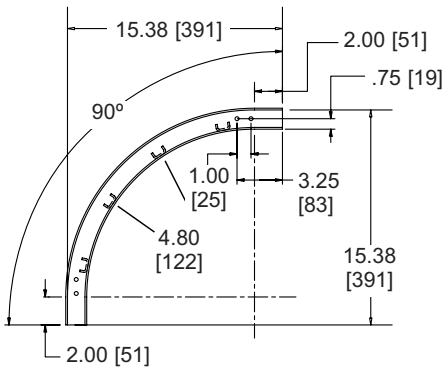

**SIDE VIEW**

**FRONT VIEW**

**CLB-VI90**

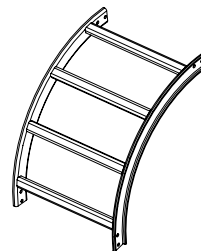
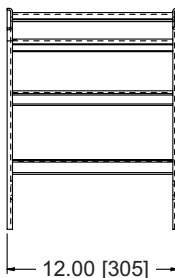
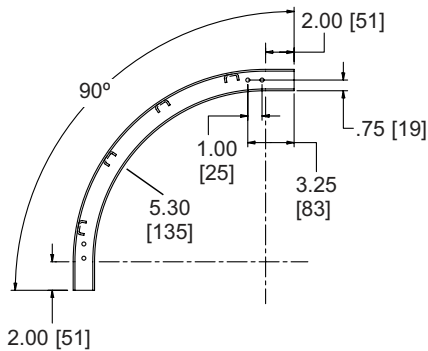

**SIDE VIEW**

**FRONT VIEW**

**CLB-V090**



**TOP VIEW**

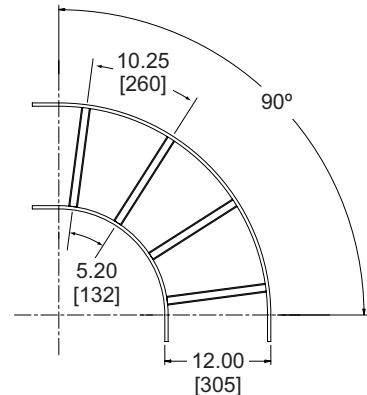

**FRONT VIEW**

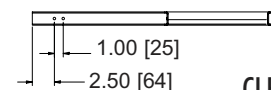

**CLB-90HB**

